

**ROMANESQUE**

- **Romanesque architecture** adalah arsitektur yang berkembang di Eropa pada akhir abad 10 sampai dengan masa Gothic pada abad 12.
- Karakteristik Romanesque architecture:
  - Bangunan massive
  - Dinding tebal
  - round arches,
  - sturdy piers, groin vaults,
  - Menara/tower
  - Langit-langit atap dekoratif

- Bangunan yang berkembang adalah
  - kastil dan gereja
  - Desa-desa pertanian
  - Menara-menara benteng
  - Hall besar sebagai pusat
  - Penjara bawah tanah dan penjara menara (Heddingham Castle, Tower of London)

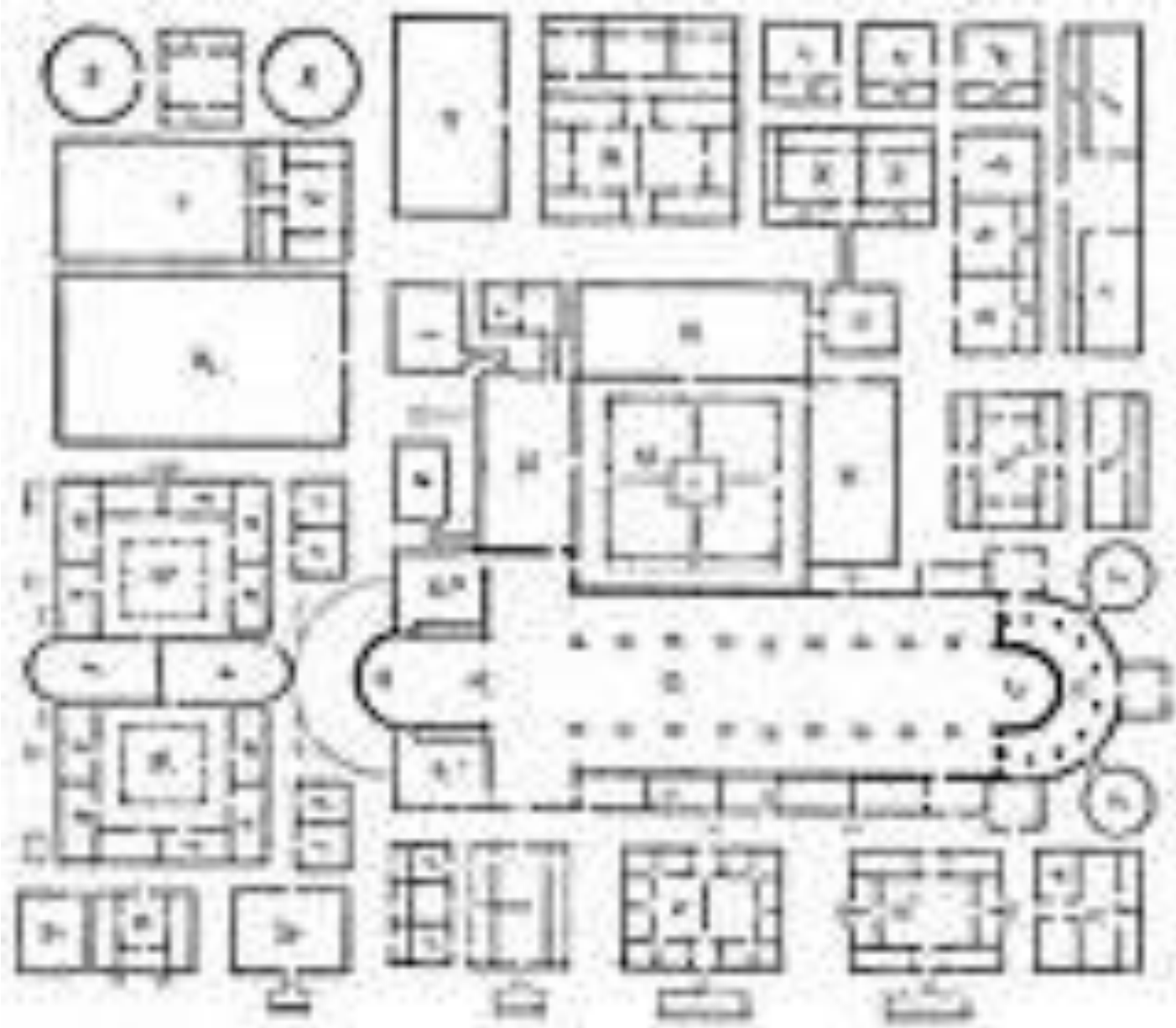

# Empat faktor yang mempengaruhi desain Romanesk (abad 10-12)

- Sistem Feodal
- Sistem Monastik
- Pensakralan benda-benda relijius dan konsep penziarahan
- Kebutuhan ganda gereja sebagai tempat kunjungan ziarah dan ritual ibadah.

- Sistem pertanian melahirkan pedesaan-pedesaan. Bukan lagi rumah-rumah individual kota (atap yang tinggi kerucut atau limasan)
- Sistem monastik melahirkan gereja yang juga berfungsi sebagai tempat tinggal para biarawan/wati, rumah kepala biara, rumah tamu, rumah sakit, toko, tempat makan, wine cellar, perpustakaan dan kandang. Karena tradisi penziarahan, biara juga menjadi tempat penyimpanan harta, Metalwork dan textil.







[Sant'Ambrogio, Milan](#) is constructed of bricks .



San Vittore alle Chiuse, [Genga](#), Italy



# Dinding

- Masif, tebal dan sedikit bukaan
- double shells, filled with rubble.
- Material lokal

## Capitals

- It is in the figurative capitals that the greatest originality is shown. While some are dependent on manuscripts illustrations of Biblical scenes and depictions of beasts and monsters, others are lively scenes of the legends of local saints. [\[4\]](#)
- The capitals, while retaining the form of a square top and a round bottom, were often compressed into little more than a bulging cushion-shape. This is particularly the case on large masonry columns, or on large columns that alternate with piers as at Durham.



- **Arches and openings**
- Arches in Romanesque architecture are semicircular
- small windows might be surmounted by a solid stone lintel, larger windows are nearly always arched. Doorways are also surmounted by a semi-circular arch, except where the door is set into a large arched recess and surmounted by a semi-circular "lunette" with decorative carving

- **Vaults and roofs**
- The majority of buildings have wooden roofs
- Vaults of stone or brick took on several different forms and showed marked development during the period, evolving into the pointed ribbed arch which is characteristic of [Gothic architecture](#).

- **Barrel vault**
- The simplest type of vaulted roof is the barrel vault in which a single arched surface extends from wall to wall, the length of the space to be vaulted, for example, the nave of a church. An important example, which retains Medieval paintings, is the vault of [Saint-Savin-sur-Gartempe](#), France, of the early 12th century. However, the barrel vault generally required the support of solid walls, or walls in which the windows were very small.[\[11\]](#)

- **Groin vault**
- A groin vault is almost always square in plan and is constructed of two barrel vaults intersecting at right angles. Unlike a ribbed vault, the entire arch is a structural member. Groin vaults are frequently separated by transverse arched ribs of low profile as at [Santiago de Compostela](#). At [La Madeleine, Vézelay](#), the ribs are square in section, strongly projecting and polychrome. [\[15\]](#)

# Church and cathedral facades and external decoration

- Romanesque church facades, are usually symmetrical, have a large central portal made significant by its mouldings or porch and an arrangement of arched-topped windows.
- Smaller churches often have a single tower which is usually placed to the western end.



# Towers

- They take a variety of forms, square, circular and octagonal, and are positioned differently in relation to the church in different countries.



# Decoration

- **Architectural sculpture**

- The Romanesque period produced a profusion of sculptural ornamentation. This most frequently took a purely geometric form and was particularly applied to mouldings, both straight courses and the curved moldings of arches.

- **Figurative sculpture**

- The purpose of the sculptural schemes was to convey a message that the Christian believer should recognise their wrong-doings, repent and be redeemed.

- **Mural**

- A classic scheme for the full painted decoration of a church, derived from earlier examples often in [mosaic](#), had, as its focal point in the semi-dome of the apse

- **Stained glass**







